

# MGH series planetary gearbox

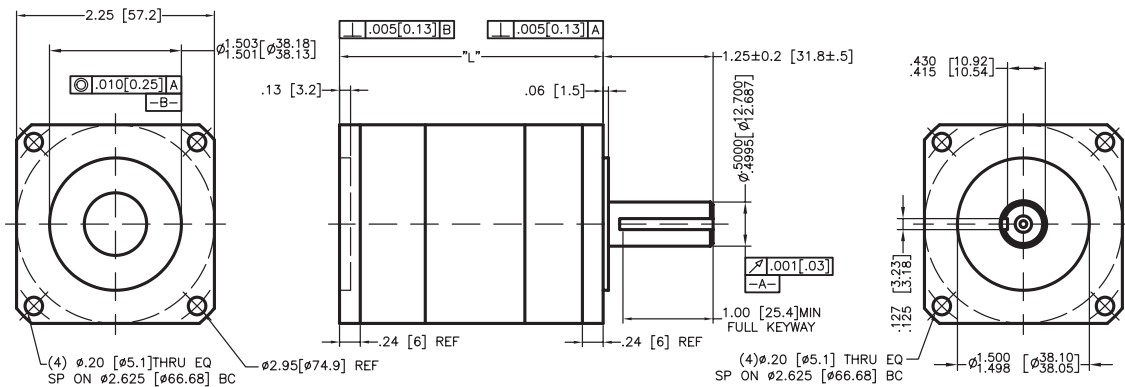

## Mechanical



- NEMA23 Standard Configuration
- All powder metal gears except adapter
- Operating Temperature Range: -17°C To +120°C
- Maximum Input Speed: 4000rpm
- Axial load 34kgs Max,  
Radial Load 34kgs max at 15mm from Shaft end

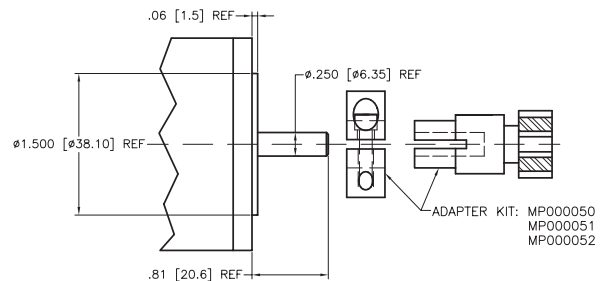

## Performance Data

Part No.	Ratio	Cont Torque (Nm)	Peak Torque (Nm)	Efficiency (%)	Stage	Weight (Kg)	Length L Max in(mm)	Adapter Part No
MGH23PI003-005	3:1	7	22	90	1	0.4	2.97[75.4]	MP000050
MGH23PI005-005	5:1	7	22	90	1	0.4	2.97[75.4]	MP000052
MGH23PI010-005	10:1	7	22	80	2	0.6	3.55[90.1]	MP000051
MGH23PI015-005	15:1	7	22	80	2	0.8	3.87[98.2]	MP000050
MGH23PI025-005	25:1	7	22	80	2	0.8	3.87[98.2]	MP000052
MGH23PI030-005	30:1	7	22	70	3	1.0	4.45[113]	MP000051
MGH23PI050-005	50:1	7	22	70	3	1.0	4.45[113]	MP000051
MGH23PI100-005	100:1	7	22	60	4	1.2	5.05[128.2]	MP000051

# planetary gearbox

## Mechanical:

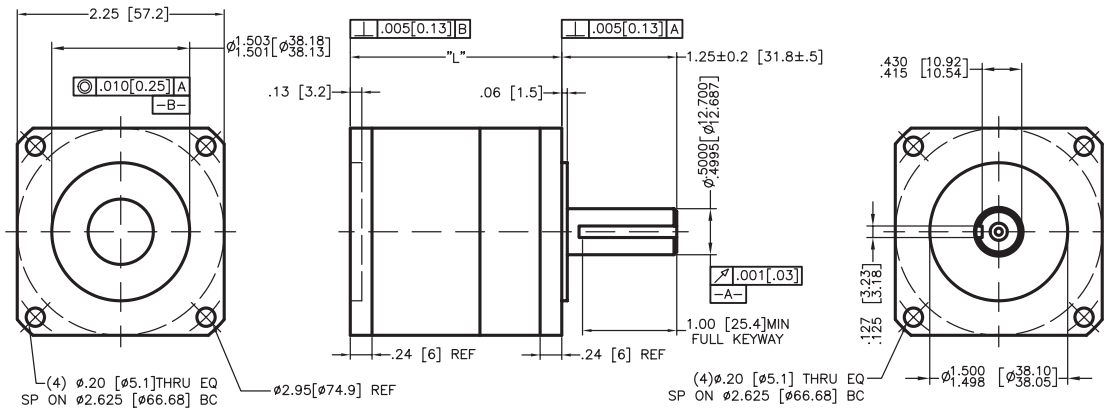

## Standard Feature

- All powder metal gears except steel input gear
- Rigid construction for industrial use
- Operating Temperature Range: -17°C To +120°C
- Maximum Input Speed: 4000rpm
- Front and Rear end caps aligned to +/-1°
- Bond pinion to shaft using loctite 680
- Axial load 34kgs Max, Radial Load 34kgs max at 15mm from Shaft end

## Motor Interface

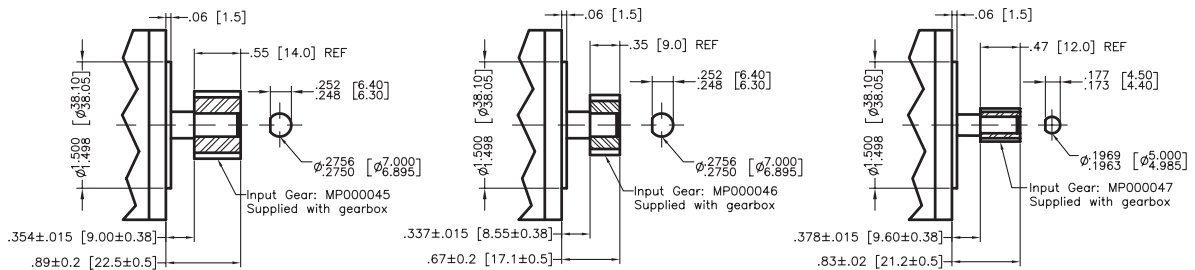

## Performance Data

Part No.	Ratio	Cont Torque (Nm)	Peak Torque (Nm)	Efficiency (%)	Stage	Weight (Kg)	Length L Max in(mm)	Pinion Part No
MGH23PI003-004	3:1	6.5	20	90	1	0.4	2.10(53.3)	MP000045
MGH23PI005-004	5:1	6.5	20	90	1	0.4	2.10(53.3)	MP000047
MGH23PI010-004	10:1	6.5	20	80	2	0.6	2.61(66.3)	MP000046
MGH23PI015-004	15:1	6.5	20	80	2	0.8	3.04(77.2)	MP000045
MGH23PI025-004	25:1	6.5	20	80	2	0.8	3.04(77.2)	MP000047
MGH23PI030-004	30:1	6.5	20	70	3	1.0	3.61(91.7)	MP000046
MGH23PI050-004	50:1	6.5	20	70	3	1.0	3.61(91.7)	MP000046
MGH23PI100-004	100:1	6.5	20	60	4	1.2	4.18(106.2)	MP000046