

Planetary Gear IG - 52

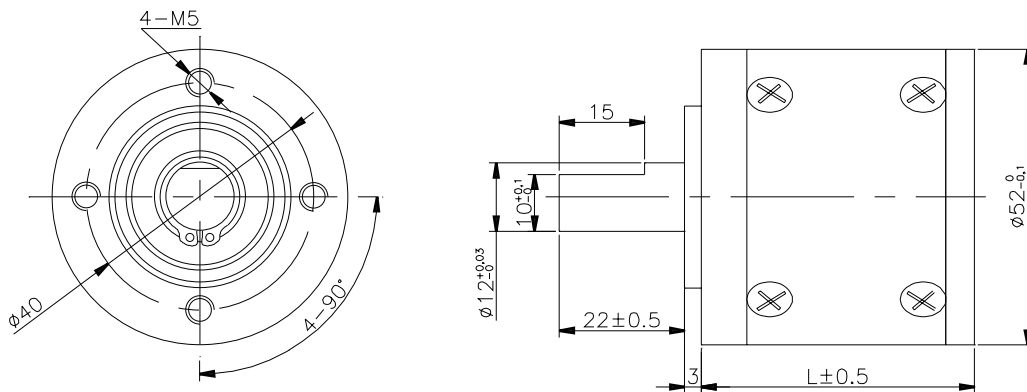

Housing material	Metal	Backlash, at no- load	$\leq 3^\circ$
Bearing at output		Ball bearings	
Radial load (10mm from flange)		≤ 20 kg	
Shaft axial load		≤ 10 kg	
Shaft press fit force , max.		≤ 30 kg	
Radial play of shaft		≤ 0.04 mm	
Axial play of shaft		≤ 0.3 mm	

Mechanical Size



Pinion Specification

Module	1.0		
No.of teeth	8	12	16
Pressure angle	20		
Hole diameter	3.98	5.98	6.34
Reduction ratio	21, 26, ,126, 156, 488, 546, 676 , 756, 936	4, 15, 19, 53, 66, 81, 113, 230, 285, 353	3, 12, 43, 150

Motor Installation

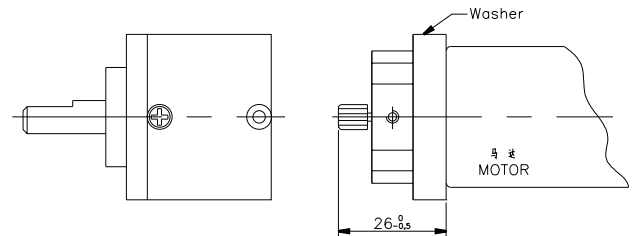

Gear ratio Specification

Reduction ratio	Rated torque (kg-cm)	Max momentary torque (kg-cm)	Efficiency (%)	L (mm)	Weight(g) Ball bearings
3, 4	15	45	80	53.0	475
12, 15	50	150	70	68.5	660
19, 21, 26	50	150	70	68.5	660
43, 53, 66	100	300	60	84.0	850
81, 100	100	300	60	84.0	850
113, 126	100	300	60	84.0	850
150	100	300	50	99.5	1020
230, 285	100	300	50	99.5	1020
353, 488	100	300	50	99.5	1020
546, 676	100	300	50	99.5	1020
756, 936	100	300	50	99.5	1020

Operating relative humidity 20%~85%RH Operating temperature range -10°C~+60°C