

# Planetary Gear IG - 42

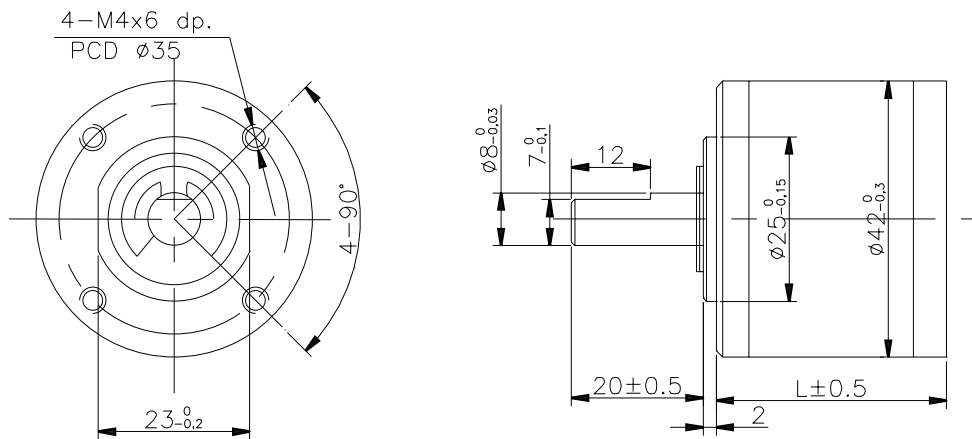

Housing material	Metal	Backlash, at no- load	$\leq 3^\circ$
Bearing at output		Sleeve bearings	Ball bearings
Radial load (10mm from flange )		$\leq 5$ kg	$\leq 8$ kg
Shaft axial load		$\leq 3$ kg	$\leq 3$ kg
Shaft press fit force , max.		$\leq 15$ kg	$\leq 15$ kg
Radial play of shaft		$\leq 0.05$ mm	$\leq 0.04$ mm
Axial play of shaft		$\leq 0.3$ mm	$\leq 0.3$ mm

## Mechanical Size



## Pinion Specification

Module	0.6			
No.of teeth	12	15	18	24
Pressure angle	20°			
Hole diameter	3.98		4.98	
Reduction ratio	24, 84, 104, 144, 504, 864	720, 1062, 1470, 2500, 3000, 3600	17, 61, 212	14, 49

## Motor Installation

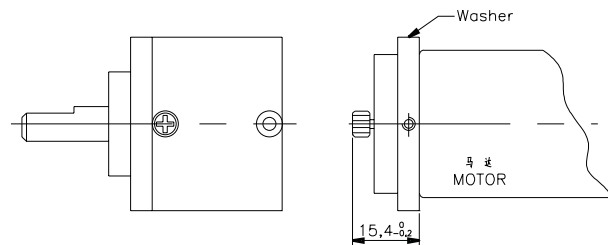

## Gear ratio Specification

Reduction ratio	Rated torque (kg-cm)	Max momentary torque (kg-cm)	Efficiency (%)	L (mm)	Weight(g) Sleeve bearings	Weight(g) Ball bearings
4	5.0	15.0	80	32.5	141	139
14, 17, 24	10.0	30.0	70	39.2	193	191
49, 61, 84	18.0	54.0	60	45.9	233	231
104, 144	20.0	60.0	60	45.9	233	231
212, 294	25.0	75.0	50	52.6	283	281
504, 624	30.0	90.0	50	52.6	283	281
720, 864	30.0	90.0	50	52.6	283	281
1062	30.0	90.0	40	59.6	328	326
1470, 2500	30.0	90.0	40	59.6	328	326
3000, 3600	30.0	90.0	40	59.6	328	326

Operating relative humidity 20%~85%RH Operating temperature range -10°C~+60°C