

DC Motor Series GE 63x25 and GE 63x55

The type GE63 motors have permanent magnets and high power at small volume and thus especially suited for industrial applications, such as

- Computer and office machines
- Pumps and compressors
- Industrial blowers
- Welding technics
- General machine construction
- Medical equipment
- Door operating drive

Design

These motors are rigidly built and need no maintenance during their lifetime.

Depending on length two versions are available with max continuous torque of 14 Ncm resp. 28 Ncm.

The motors can be combined with different encoders .

The GE 63 series motors can be delivered with brakes and/or actual value encoders .

Standard version without second drive shaft and without connector

Features

- Mount-on dimensions according to DIN 42016.
- Independent of mounting position.
- Clockwise and counter-clockwise rotation.
- Insulation according to VDE 0530, insulation class B.
- Surface protection.

Standard program

Motors with nominal voltages 12V, 24V, 40V, and 60V represent our standard motor program and should preferably be used.

Load characteristics

The data are examples for the standard program with the possible winding configurations of the motors, type GE 63.

Performance data of motor GE 63x25					
Nominal voltage	V	24	40	60	12
Nominal speed	Min ⁻¹	3300	3500	3300	3100
Nominal torque	Ncm	14	13.3	14.5	13.7
Nominal current	A	2.7	1.65	1.1	5.2
Demagnetization current	A	24	16	9.5	50
No load speed	Min ⁻¹	3600	3800	3600	3600
No load current	A	0.36	0.205	0.135	0.6
Starting torque	Ncm	108	118	116	82
Efficiency	%	74	74	76	71
Moment of inertia	gcm ²	400	400	400	400
Weight	kg	1.2	1.2	1.2	1.2

Performance data of motor GE 63x55					
Nominal voltage	V	24	40	60	12
Nominal speed	Min ⁻¹	3350	3450	3350	3000
Nominal torque	Ncm	27	27	28.3	24
Nominal current	A	4.9	2.95	2.0	8.7
Demagnetization current	A	33	20	13	66
No load speed	Min ⁻¹	3650	3600	3600	3500
No load current	A	0.4	0.28	0.2	0.8
Starting torque	Ncm	211	210	200	202
Efficiency	%	80	82	82	80.5
Moment of inertia	gcm ²	750	750	750	750
Weight	kg	1.7	1.7	1.7	1.7
Shaft load capacity axial max	150N				
Shaft load capacity radial max	150N applied 20 mm from mounting surface				



Series GE 63x25 and GE 63x55

Mechanical Dimensions

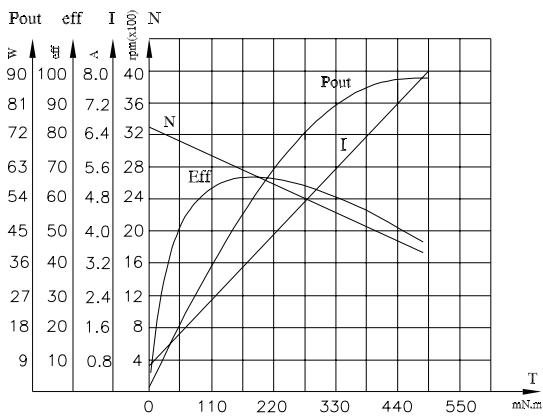
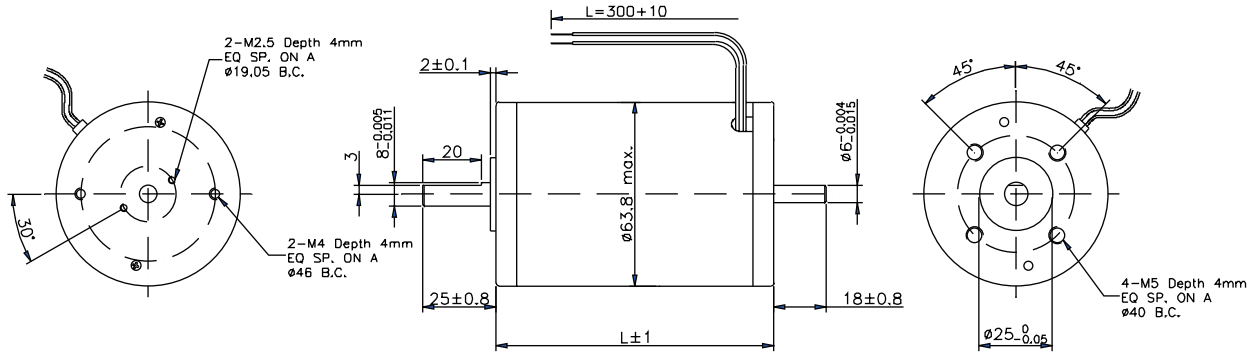

Typical Curve - A

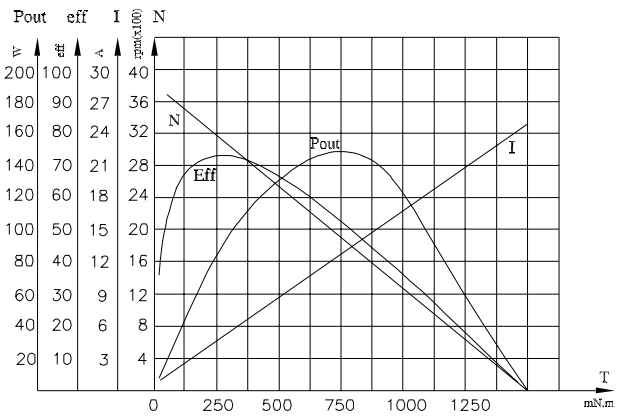

Typical Curve - B

Customization

- Special Shaft Configuration
- Leadwire With Connectors
- With Brake
- With Gearbox
- With Encoder